

HR0101A-SPEC

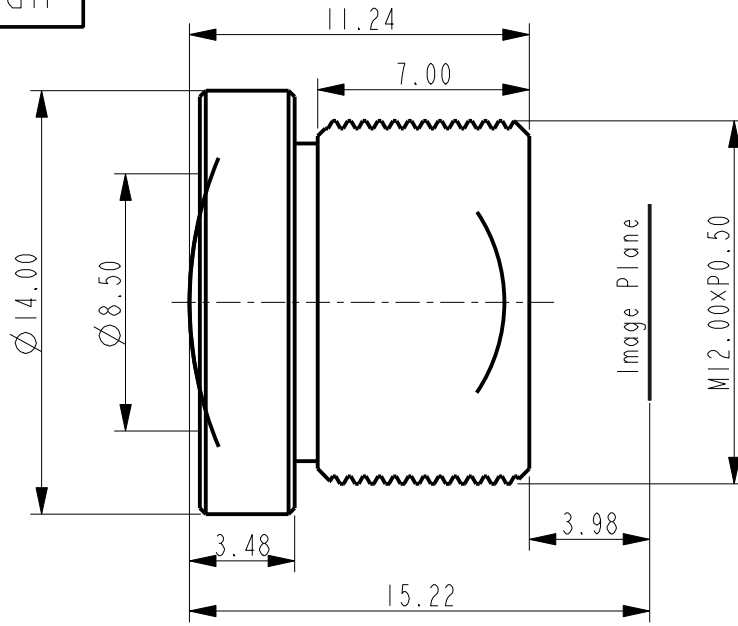

### Lens Specification

NO	SPECIFICATIONS		PARAMETER
1	Model Name		HR0101A
2	Sensor		1/3" (6mm×4.8mm×3.6mm) 3M
3	Pixel Size		3.0 $\mu$ m
4	Image Circle(Max.)		6.50mm
5	EFFL(Effective Focal Length)		2.59±0.1mm
6	F-Number		2.3±5%
7	TTL(Total Length)		15.22mm
8	FBL(Flange Back Length)		3.98mm
9	BFL(Back Focal Length)		4.79mm
10	View Angle	Diagonal	156° (2Y' = 6.25mm)
		Horizontal	132° (2Y' = 5.44mm)
		Vertical	70° (2Y' = 3.07mm)
11	MTF	Center	32.6% @ 300lp/mm
		0.7Field	T23.4%, S53.3% @ 200lp/mm
		0.9Field	T20.9%, S44.8% @ 200lp/mm
12	Distortion	Optical	≤ -32.16%
		TV(Trad.)	≤ 17.4%
13	Relative illumination	1.0Field	64%
14	Chief Ray Angle(Max.)		13°
15	Lateral Color(Max.)		≤ 5.25 $\mu$ m
16	IR Filter Thickness		0.3mm/镜头不带IR
17	Object Distance		30cm-1nf
18	Therad		M12×P0.50mm
19	Operating Temperature		-20°C~+80
20	Storage Temperature		-20°C~+80



江西高端光电股份有限公司

比例 4:1 页码 1/1

重量 (g) 材料

标记	处数	区域	更改内容	担当	时间
承认	审核	工艺	设计	时间	

名称 HR0101A规格书 REV.

编号 HR0101A-SPEC A0